



RV MicroLite™ 2300 50 Hz GenSet



RV GenSet

- **Lightweight**
- **Gasoline or LP Fueled**
- **Quietest Generators of their Size**
- **Easy Maintenance with Single-Side Service**
- **Completely Enclosed, Quick, Easy to Install**
- **3-Year Limited Warranty**
- **Low Fuel Consumption**

Ratings and Models

Model	Fuel	Hz	RPM	Watts	Voltage	Amps	Phase	Circuit Breaker
2.3KV-FR/33742	Gasoline	50	3000	2300	230	10.0	1	10A
2.3KV-FR/51844	Gasoline	50	3000	2300	230	10.0	1	10A
2.0KV-FR/26119	LP Vapor	50	3000	2300	230	10.0	1	10A

- Watts and amps shown above are intermittent. Continuous watts: 2000 for all models.
- Ratings apply to altitudes up to 150 m, 30° C.
- Derating: Power output will decrease 11.5% for each 1000 m above 150 m, 2% for each 10° C increase in ambient temperature above 30° C.
- Intermittent rating capability: 5 minutes maximum.
- Continuous rating applies to all voltages (220-240) @ 1.0 power factor. Contact your Onan distributor for derate information at other power factors.

Weight, Size and Sound Level

- Weight: 51 kg
- Length: 610 mm; Width: 418 mm; Height: 311 mm
- 50 Hz 64 dB(A) @ 7 m before installation*, full load

*Typical installation will further reduce sound level.

Standard Features

- Onan sound attenuating enclosure
- Focalized mounting system with vibration isolators
- Cross-Flo cooling
- Sheet steel drip-controlling base
- Enclosed muffler
- USDA Forest Service approved spark arrestor muffler
- Adjustable mechanical governor
- Automatic choke
- Engine preheat
- Overhead valves
- Single-side service
- Low oil level shutdown
- Electric fuel pump (Gasoline); electric solenoid (LP)
- Mounted control panel
- Connector for remote 3-wire start
- Electric start
- Fused DC circuits to protect set wiring and remote control wiring
- Magnetic circuit breaker
- 1.3 m generator output leads
- Solid-state ignition

Engine Detail

Model: Onan GH-200
Design: 4-cycle, single cylinder, overhead valve
Displacement: 197 cm³
Compression Ratio: 8.5:1
Power: 5.8 hp Gasoline; 5.2 hp LP
Cooling: Pressurized air
Fuel System: (Gasoline) electric fuel pump, fuel lift 900 mm; (LP) Electric fuel solenoid; automatic choke
Combustion Air: 50 Hz: 0.3 m³/min at 3000 r/min.

Ignition System: Breakerless, electronic
Starting System: Remote, 12 V, 3-wire negative ground
 Start-Stop Rocker Switch on control
 Connector for remote start cable
Lubrication: Splash lubrication
Oil Capacity: 0.95 L
 Low oil level shutdown
Cylinder-crankcase: Alloy aluminum with iron cylinder liner cast into the block, aluminum oil base
Cylinder Head: Alloy aluminum, removable

Average Fuel Consumption:

Gasoline	No Load		Half Load		Full Load	
	gph	l/h	gph	l/h	gph	l/h
50 Hz 2.3 KV	0.2	(0.80)	0.23	(0.90)	0.4	(1.5)

LP	No Load		Half Load		Full Load	
	gal/h	lb/h	gal/h	lb/h	gal/h	lb/h
50 Hz 2.0 KV	0.85	(0.39)	1.28	(0.58)	1.92	(0.87)

Generator Detail

Design: Onan, 2-pole self-excited revolving field. Permanently aligned to engine by a tapered shaft. Drip-proof construction.
Insulation System and Temperature Rise: Meets BS-4999 standards.
Cooling: Direct drive centrifugal blower. Air required (including engine cooling air): 7.1 m³/min at 3000 r/min.

Rotor: Laminated electrical steel assembly press-fitted to shaft, balanced, heavy insulated copper wire windings.
Stator: Laminated electrical steel assembly skewed for excellent waveform. Heavy insulated copper wire windings.
Voltage Regulator: Electronic
DC Brushes: Electrographitic

GenSet Performance

Air Conditioner Operation:
Gasoline: 150 m and 40°C: The 2.3 KV will start and run one 6100 Btu air conditioner with a 1000 W baseload.
LP: 150 m and 40°C: the 2.0 KV will start and run one 6100 Btu air conditioner with a 700 W baseload.

Voltage Regulation: Exceeds requirements of ±10%
Frequency Regulation: ±5%

Basic Dimensions

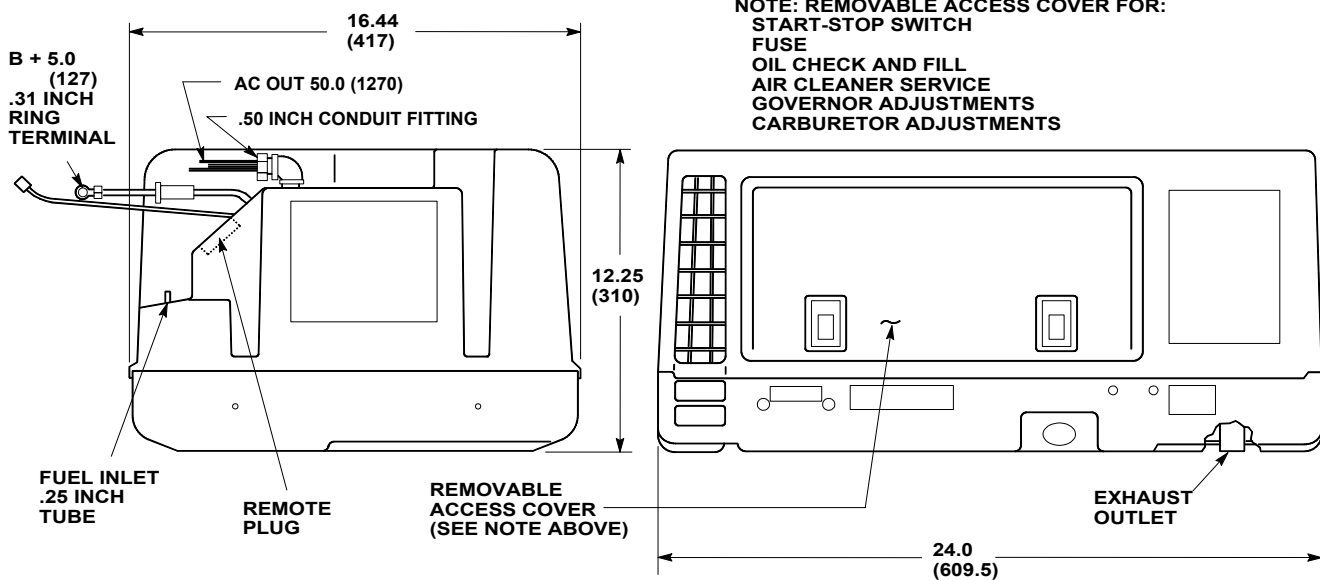

Dimensions in parentheses are millimeters. This outline drawing is provided for general reference only and is not intended for design or installation. For more information see installation manual and wiring diagram from your Distributor/Dealer.

Underfloor Mounting Kit (Part #403-2689) Microlite 2300

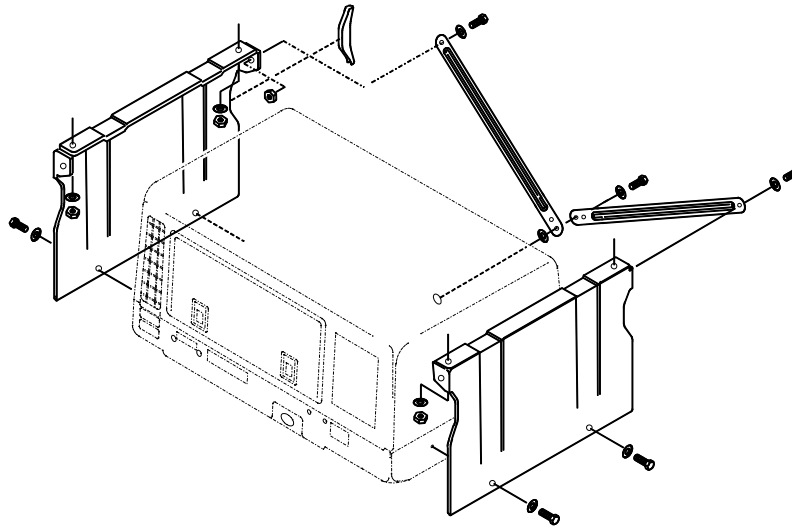

Caution: Drawings are supplied for reference only and should not be used for design or installation.

Options and Accessories

- Remote start/stop rocker switch (P/N 300-4936)
- Remote Control with start/stop switch, and running time meter (P/N 300-4937)
- Remote control w/start/stop switch, and DC voltmeter (P/N 300-4938)
- Remote control plug and wire harness (10 ft - P/N 338-3489-01; 30 ft. - P/N 338-3489-02)
- Battery, 12V, 360 cold cranking amps at 0°F (-18°C) (P/N 416-0717)
- Under floor mounting kit (P/N 403-2689)
- Tailpipe for 18-25 in exhaust installations (P/N 155-2174)
- Exhaust kit for installations over 25 in (P/N 1550-2449)
- Exhaust down tube kit (P/N 155-2425)
- Compartment mount installation template (P/N 539-1386)
- Under floor mount installation template (Included in under floor mounting kit P/N 403-2689) (P/N 539-0978)

Onan Testing for RV Application

Tested at extremes of temperature -20° F (-29° C) to 120° F (49° C) for starting and operation.
Tested with RV loads, air conditioners, microwaves, converter, TVs, VCRs.
Tested installed. Onan owns RVs used for product development testing.
Tested in high humidity conditions.
Tested in salt spray conditions.
Tested in heavy airborne dust conditions.
Field Test program.
Ratings apply to altitudes up to 500 ft (150 m), 85° F (29° C) ambient with muffler, in RV enclosure.



Operating Temperature Range

Gasoline sets will operate from -20°F (-29°C) to 120°F (49°C). LPG sets will operate from 0°F (-18°C) to 120°F (49°C). LPG set starting and operation below 32°F (0°C) depends upon LP tank capacity, surface area and butane content of LPG.

Warranty Policy

The Limited Warranty covers virtually everything except routine maintenance for the first two years you own your RV generator, and covers parts and labor on major power train and generator set parts during the third year. In addition, it also includes a free 90-day adjustment policy, which provides that Onan will make minor adjustments to your new genset during the first three months you own it - free of charge! Please note: The Onan 3-year Limited Warranty applies to RV generators used in RV applications only, and does not apply to RV generators used in commercial mobile applications.

For complete Onan Limited Warranty details see your Cummins Distributor or Onan Certified RV Service Dealer.

After Sale Support

For your ongoing satisfaction and the dependability of your Onan RV generator, Onan offers a complete line of replacement and tune-up parts and oil and maintenance chemicals specifically designed for RV generators. Easy to find at certified Onan RV Service and Parts Dealers coast-to-coast, Onan Green Label Parts™ are packaged for correct selection and convenient on-board storage.

EASY TO LOCATE ONAN CERTIFIED RV SERVICE AND PARTS DEALER - Onan has trained, tested, and certified over 1000 dealers covering most major metropolitan areas in the U.S. and Canada. To easily locate a certified dealer, no matter where you travel, call 1-800-888-ONAN and ask us to send you an RV Service and Parts Dealer Directory (F-919) or visit www.funroads.com.



See Your Distributor for More Information:



Cummins Power Generation
1400 73rd Avenue N.E.
Minneapolis, MN 55432
763.574.5000
1-800-888-ONAN
Fax 763.574.8289
www.funroads.com

Cummins Power Generation is a subsidiary of Cummins Inc.
Onan is a Registered Trademark of Cummins Inc.

Cummins Power Generation is a subsidiary of Cummins Inc.
Onan is a Registered Trademark of Cummins Inc.

WARNING: Backfeed to a utility system can cause electrocution and/or property damage. Do not connect to any building electrical except through an approved device or after building main breaker is open.

